

# Touchless Clip Dispenser

## Service Manual

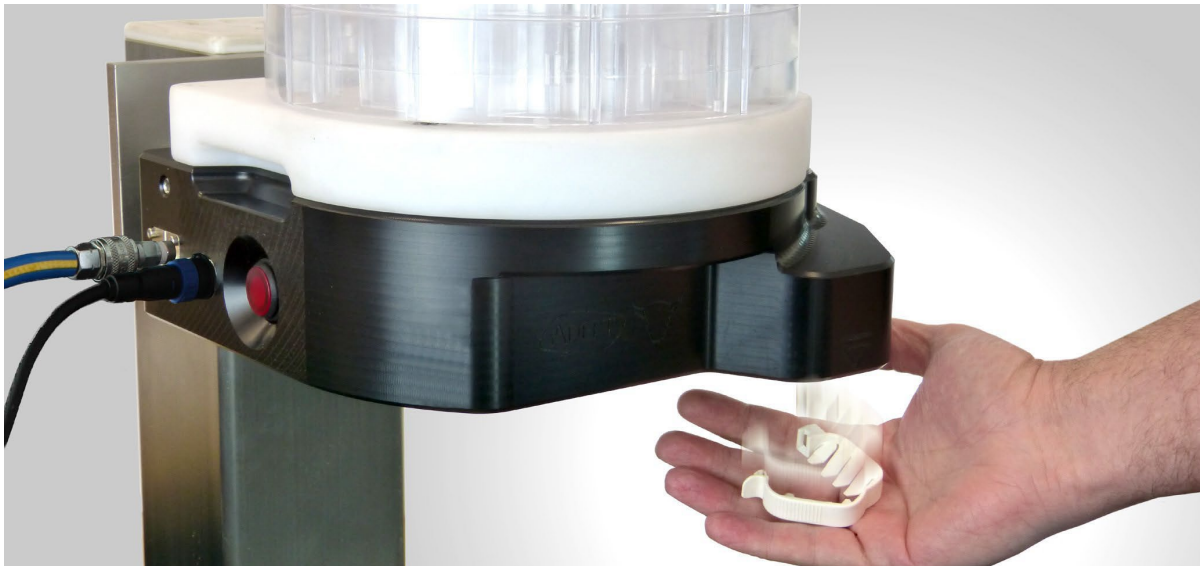

[www.adeptclip.com](http://www.adeptclip.com)

## Table of Contents

1. Important servicing information .....	3
2. IR Sensor (1020-061) replacement .....	4
3. Power Switch (1020-112) replacement.....	7
4. Power Connector Binder (1020-070) replacement .....	8
5. PCB (1020-062F) replacement.....	10
6. Pneumatic Solenoid Valve (1020-074) Replacement .....	13
7. Pneumatic Cylinder (1020-073) Replacement.....	18
8. Appendix A: Wiring Schematic .....	21
9. Appendix B: Main Assembly Diagram and Parts List.....	22
10. Appendix C: IR Sensor Assembly and Parts List .....	24
11. Appendix D: Carousel Assembly and Parts List.....	25

## 1. Important servicing information

For all part replacement or maintenance on the dispenser please follow the below steps:

1. **Always** disconnect the air supply line to the dispenser before servicing to prevent possible activation.
2. **Always** disconnect the power supply cable by unscrewing the collar and pulling the plug free before servicing to prevent possible activation.
3. **Always** place the dispenser on a stable flat surface before servicing.
4. Use a 2.5mm Allen key to remove the thirteen M4 cap screws on the underside of the dispenser base and remove the stainless-steel cover plate to gain access to the internal components.

**Please Note:** Do not over tighten the cap screws when reassembling the cover plate as the threads may get damaged.



5. When replacing the cover plate, the large outer O-ring may require some encouragement to settle into groove. It is the correct size and will fit once worked into the groove correctly. Run your finger around the O-ring multiple times and it will work its way in to the groove and sit flat.

**Please Note:** Do not cut the O-Ring to fit. This will compromise the seal of the dispenser.



## 2. IR Sensor (1020-061) replacement

1. Remove the sensor lead from the IR Sensor by unscrewing the collar and pulling the plug out.
2. Remove the two O-rings, O-ring carrier, Backup Ring and Glass window from the Sensor Mount.

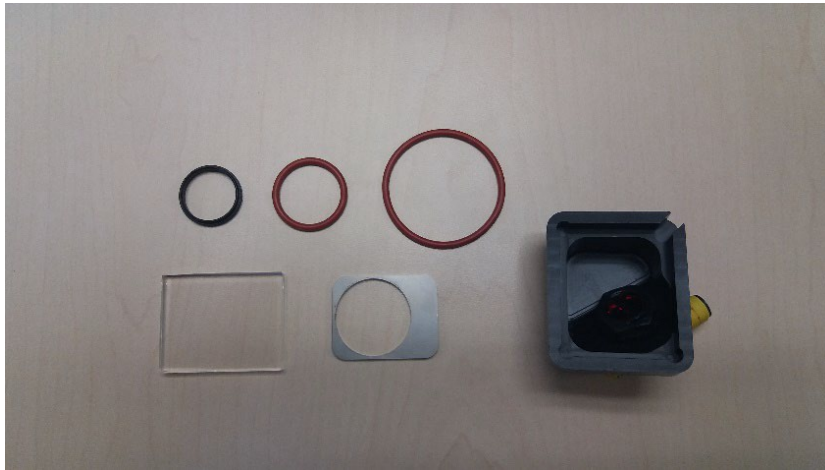

3. Using long nose pliers or similar, unscrew the IR Sensor retaining nut

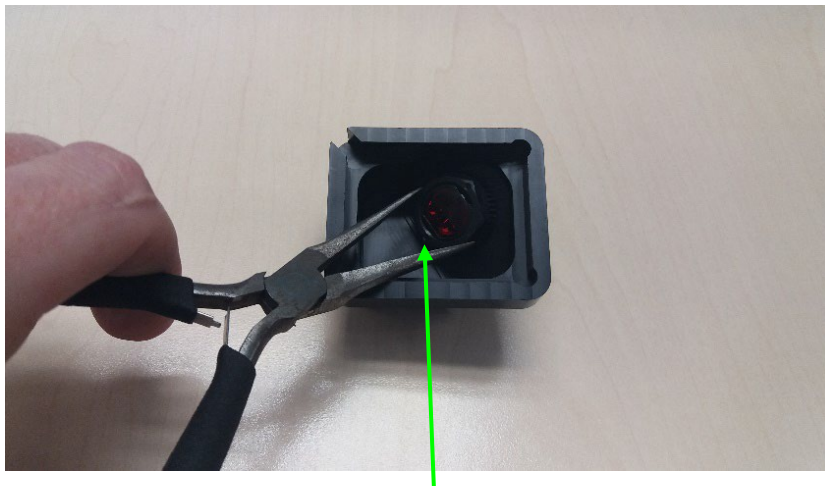

4. Reassemble using a new IR Sensor (1020-061). Ensure IR sensor retaining nut is done up tight.



**Please Note:** Sensor comes pre-calibrated to correct detection range.

5. Ensure the IR sensor is orientated correctly in the Sensor Mount (1020-095B) as below



6. Ensure the glass window is clean. Refit the Glass window into the Sensor Mount, then fit the O-ring Carrier and both the large and small O-Rings as per below.



7. Refit the Backup Ring, ensure that the step in the Backup Ring faces upwards as per below.

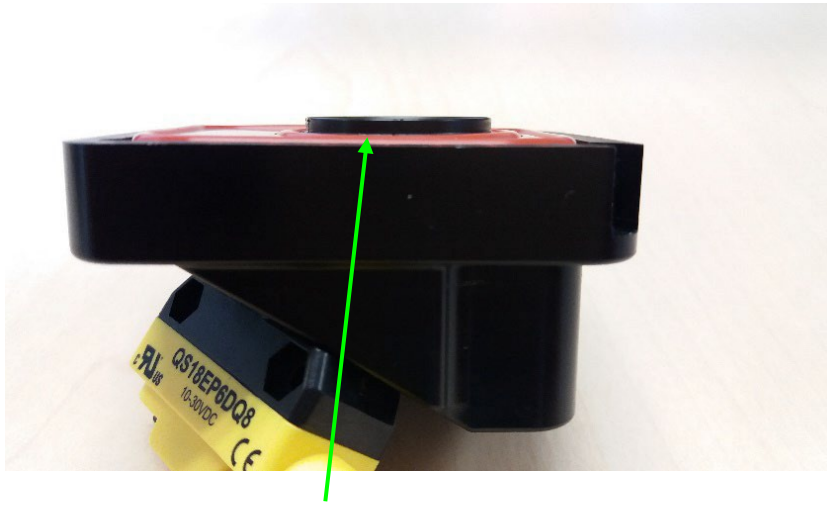

*Backup ring step facing upward*

8. Re-attach the sensor lead, the connector is keyed so will only fit in one orientation. Screw up the plug retaining sleeve.

### 3. Power Switch (1020-112) replacement

1. Disconnect the **Red/Blue**, **Green** and **Black** switch wires from the PCB by loosening the terminal screws (from left to right) **3, 4 and 5**.

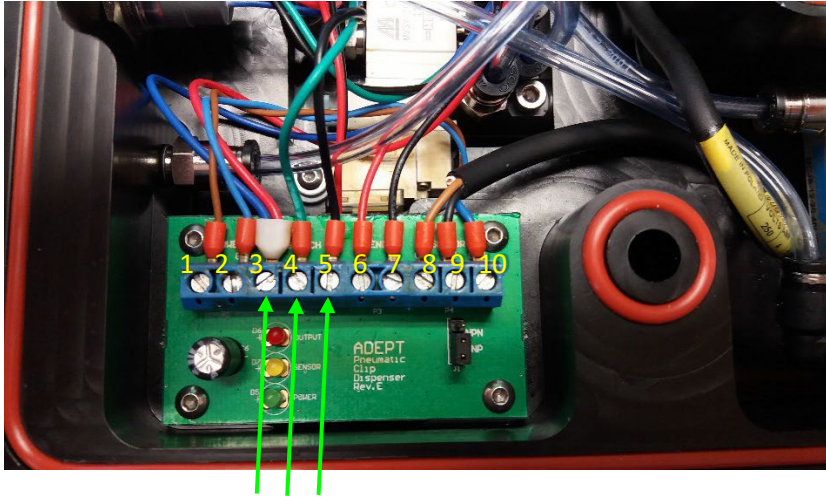

*Loosen terminal screws 3,4 and 5*

2. Remove the airline exhaust tubes from the push-in connectors to improve access. Unscrew the switch retaining nut using long nose pliers or similar.

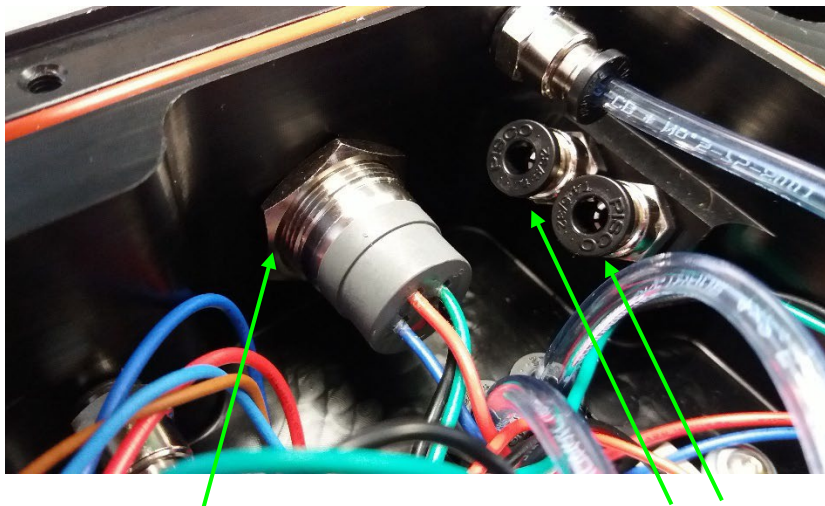

*Retaining Nut*

*Airline exhaust tubes removed*

3. Push the Power Switch out of the dispenser base.
4. Refit replacement switch, taking care to ensure the switch O-ring is seated correctly.
5. Reinstall switch retaining nut.
6. Reconnect the **Red/Blue**, **Green** and **Black** wires to the PCB. Reattach the airlines, ensure cover plate O-rings are correctly positioned, replace the stainless- steel cover plate and M4 cap screws.

## 4. Power Connector Binder (1020-070) replacement

1. Loosen the PCB terminal screws **1** and **2** on the left side of the PCB and remove the **Brown** and **Blue** wires by gripping the bootlace terminals using long nose pliers.

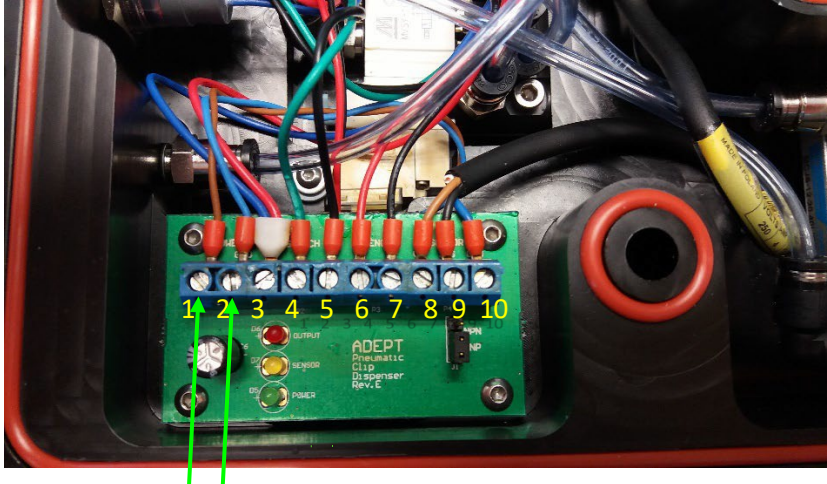

*Loosen terminal screws 1 and 2*

2. Unscrew the four M3 button head screws holding the Power Connector to the outside of the dispenser base.

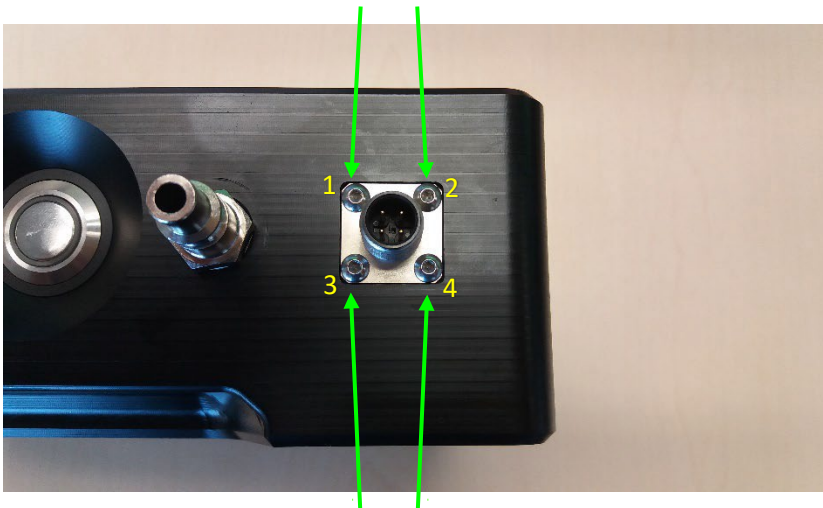

*Remove the four M3 button head screws*

3. Pull the Power Connector out of the dispenser body, carefully feeding the wires through from the inside.
4. Thread the new Power Connector wires through the hole on the base and route them neatly back to terminals **1** and **2** on the PCB.



5. Insert the Power Connector into the base hole, ensuring the O-ring is seated correctly. Refit the four M3 button head retaining screws.
6. Screw the **Brown** wire to terminal **1** and the **Blue** wire to terminal **2**.
7. Ensure cover plate O-rings are correctly positioned and replace the stainless-steel cover plate and cap screws.

## 5. PCB (1020-062F) replacement

1. Loosen all the PCB terminal screws (1 to 10) and remove the wiring by gently pulling out the bootlace connectors using long nose pliers.

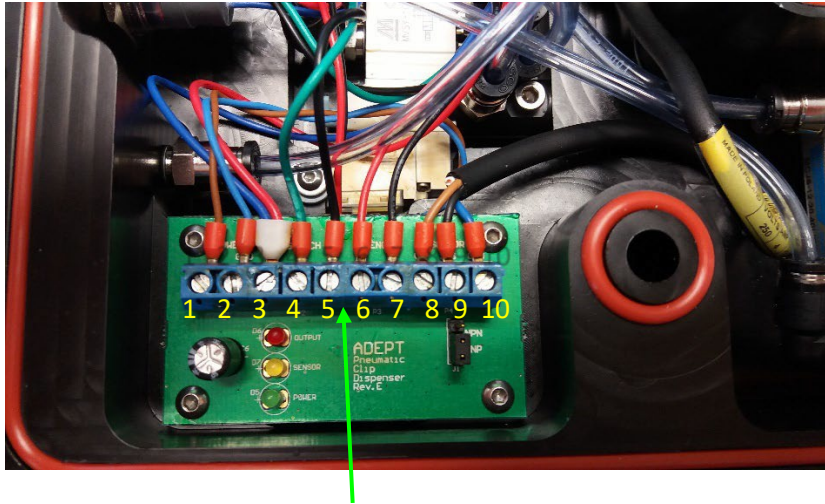

*Loosen all PCB screw terminals and remove wiring*

2. Unscrew the four M3 cap screws holding the PCB in place.

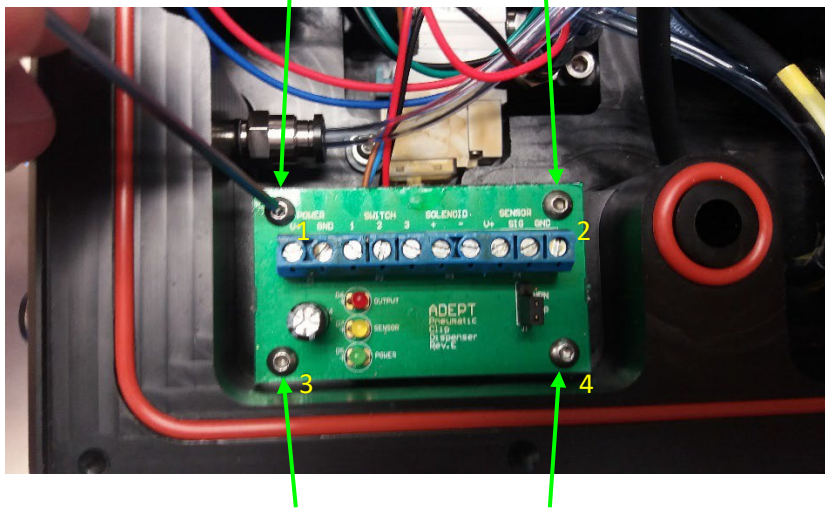

3. Ensure the jumper on the new PCB is set to the 'PNP' position prior to installation.

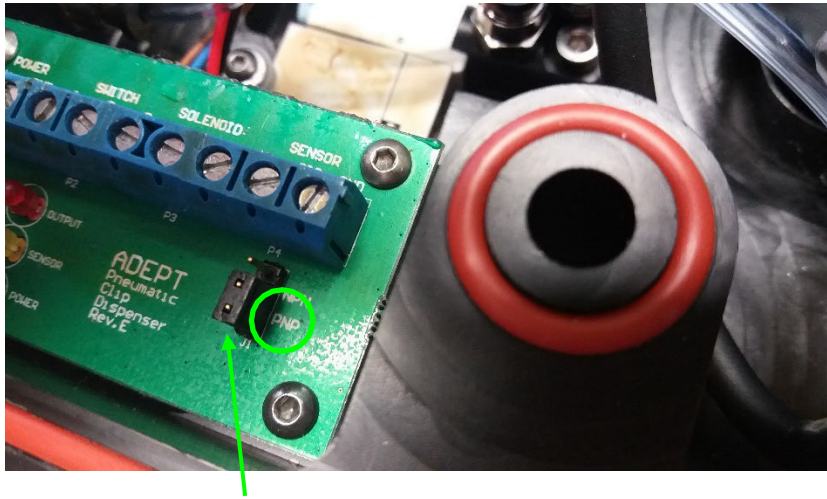

*Set jumper to 'PNP' position*

4. Locate the four PCB spacers correctly above the PCB mounting holes in the dispenser base.

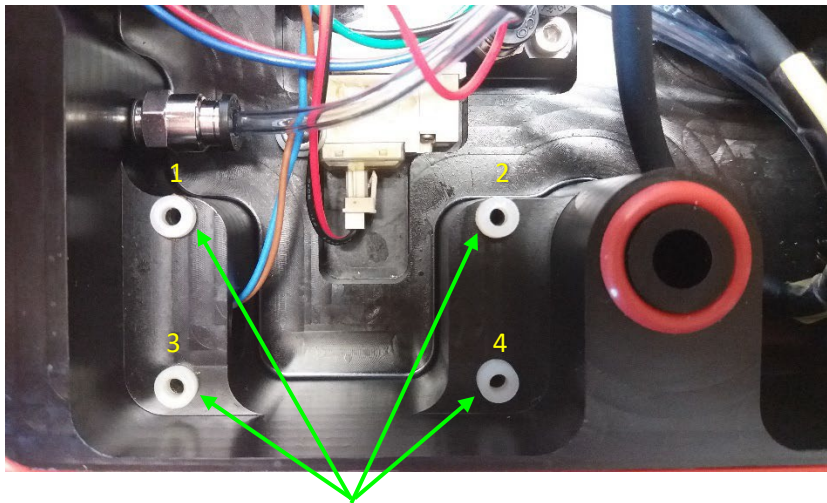

*Align PCB spacers over the screw mounting holes*

5. Install the new PCB in position using the four M3 cap screws.



6. Reconnect all wiring back to the PCB as per below:

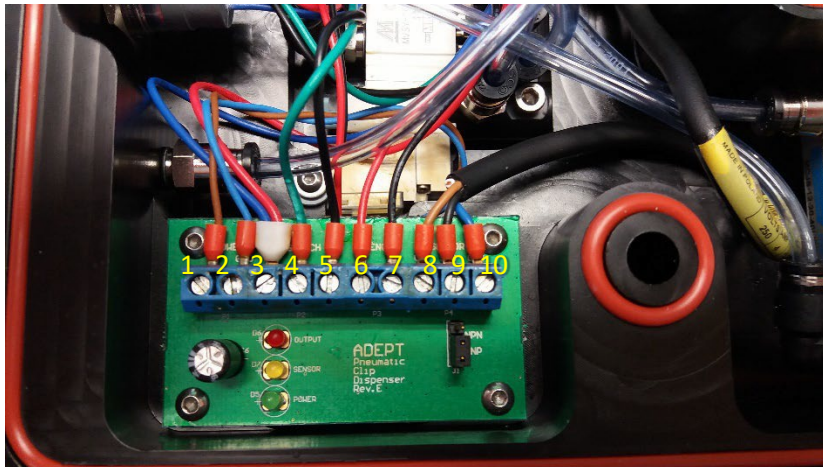

The wiring guide is as follows:

Terminal	Wire Colour	Component
1	<b>Brown</b>	Power Connector Binder
2	<b>Light Blue</b>	Power Connector Binder
3	<b>Blue/Red</b>	Power Switch
4	<b>Green</b>	Power Switch
5	<b>Black</b>	Power Switch
6	<b>Red</b>	Pneumatic Valve
7	<b>Black</b>	Pneumatic Valve
8	<b>Brown</b>	IR Sensor
9	<b>Black</b>	IR Sensor
10	<b>Blue</b>	IR Sensor

7. Ensure cover plate O-rings are correctly positioned. Replace the stainless-steel cover plate and the M4 cap screws.

## 6. Pneumatic Solenoid Valve (1020-074) Replacement

1. Disconnect the six airlines from the valve to provide access to the Solenoid Valve. The airlines are fitted using push in fittings and can be pulled out by pushing down on the outside of the fitting while pulling on the airline.

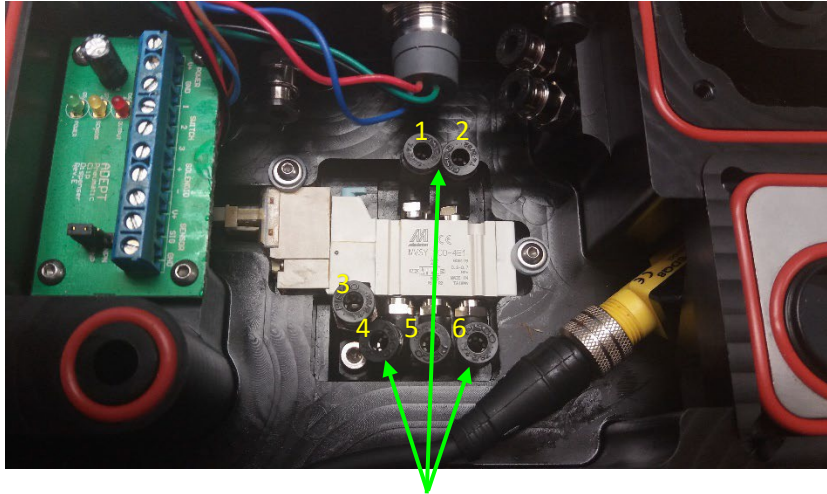

*Airlines removed*

2. Remove the two M3 cap screw (Including SS Washer and Plastic Washer) and one M5 cap screw holding the Solenoid Valve in place and remove from the recess in the dispenser base.

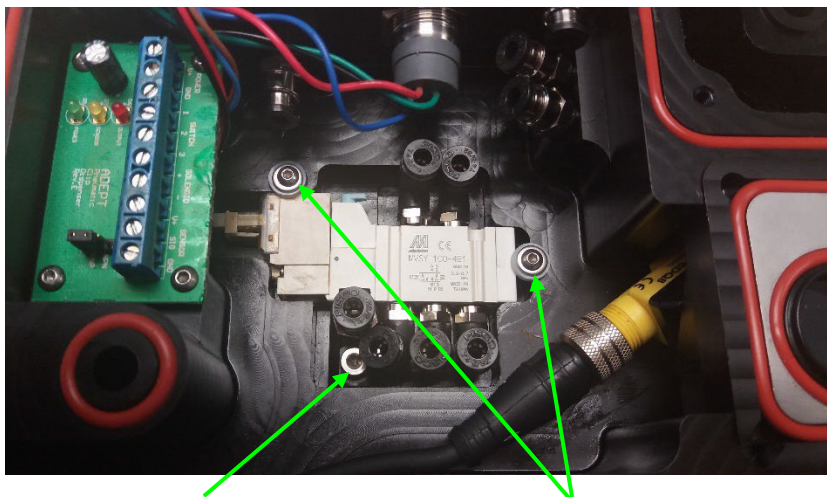

*M5 cap crew*

*M3 cap screw, Washer and Plastic Washer*

3. Separate the Vent Block from the Solenoid Valve body.

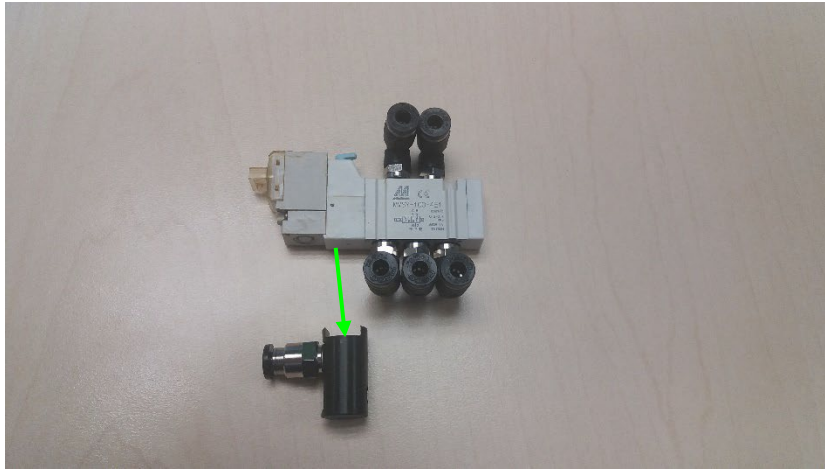

*Remove Vent Block*

4. Remove the five elbow fittings from the old valve install them to the new replacement valve. Use an 8mm open ended spanner to undo each fitting. When refitting to the new valve, make sure the orientation of the fittings is upwards. Be careful not to overtighten the elbow fittings.

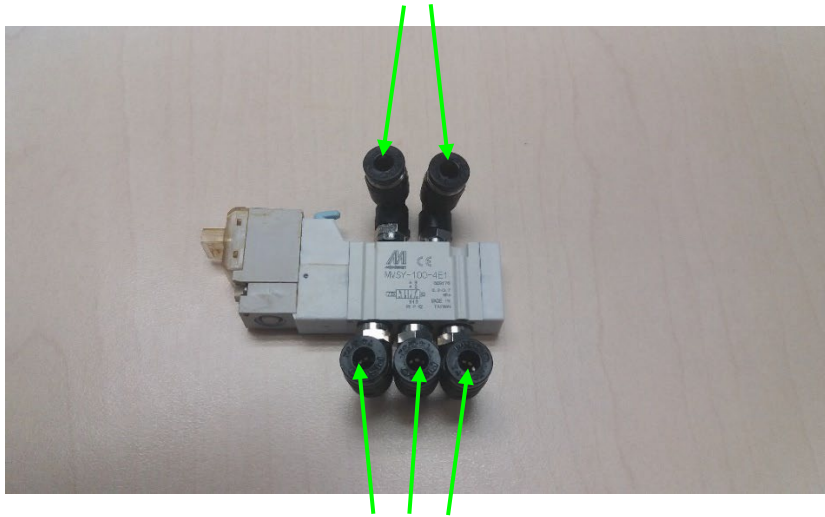

*Remove all five elbow fittings and install on to new valve*

5. Refit the Vent Block to the Solenoid Valve, ensure the small O-ring is in position in the Vent Block.



*Vent Block O-ring installed*



*Vent Block seated on Solenoid Valve*

6. The new valve comes fitted with an unterminated wire harness, discard this and connect the new valve to the existing harness from the old valve. Refit the valve into its recess and secure with the two M3 screws and one M5 cap screw, reversing the disassembly process.

7. Refit the airline main inlet connection **A** to the Solenoid Valve connection **5**.

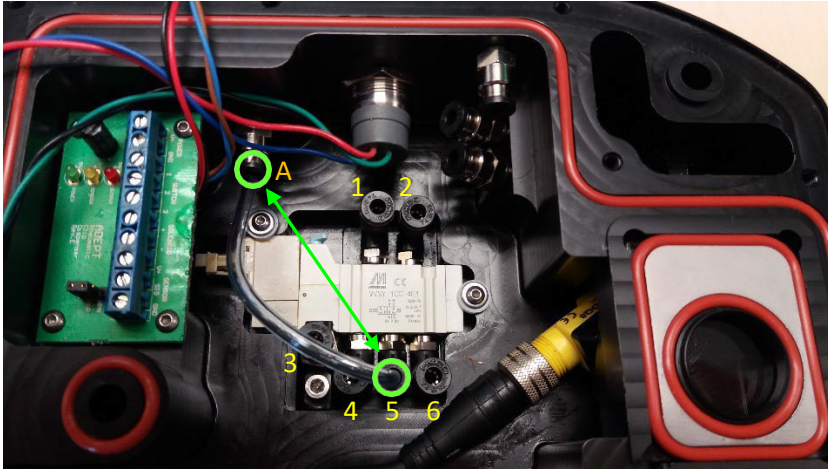

8. Refit the exhaust airline connection **B** to Solenoid Valve connection **4**. Refit the exhaust airline connection **C** to Solenoid Valve connection **6**.

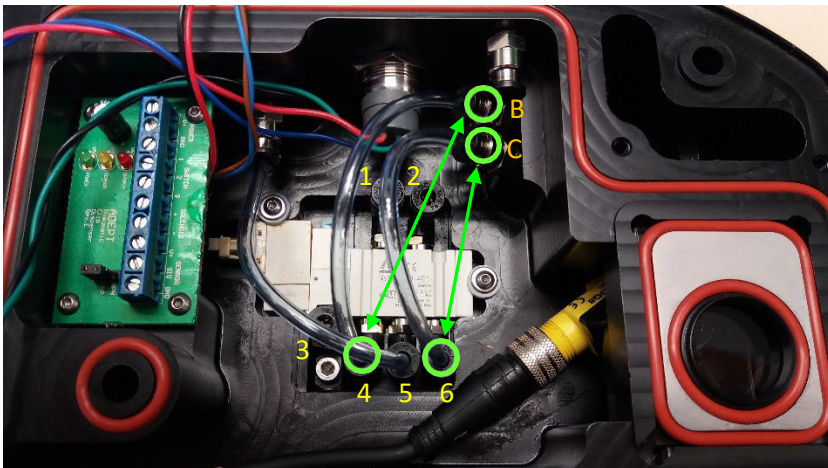

9. Refit the Pneumatic Cylinder connection **D** to Solenoid Valve connection **1**. Refit the Pneumatic Cylinder connection **E** to Solenoid Valve connection **2**.

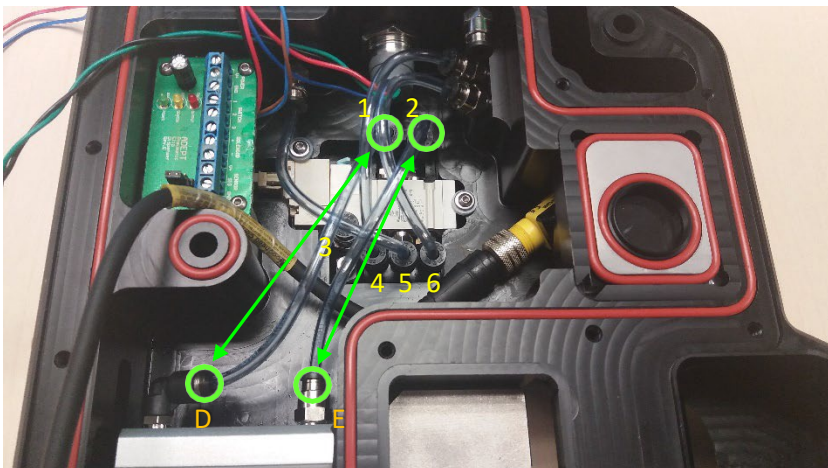



- 10.** Refit the vent airline connection **F** to Solenoid Valve connection **3**.

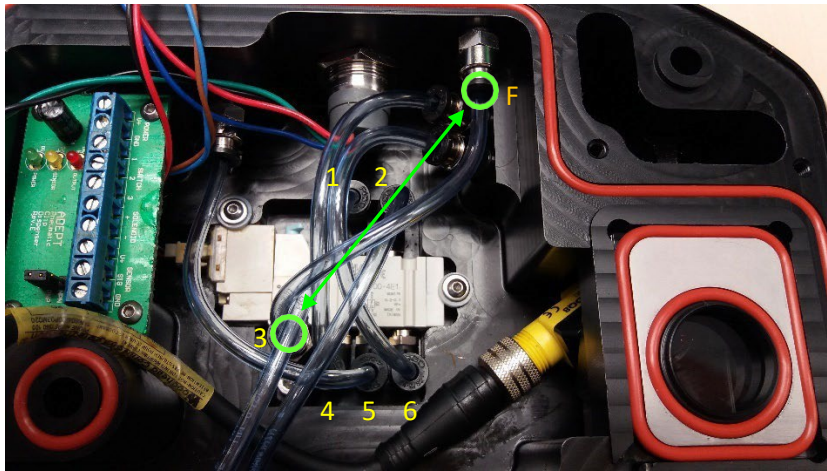

- 11.** Ensure cover plate O-rings are correctly positioned. Replace the stainless-steel cover plate and the M4 cap screws.

## 7. Pneumatic Cylinder (1020-073) Replacement

1. Disconnect the Pneumatic cylinder air line connections **D** and **E**.

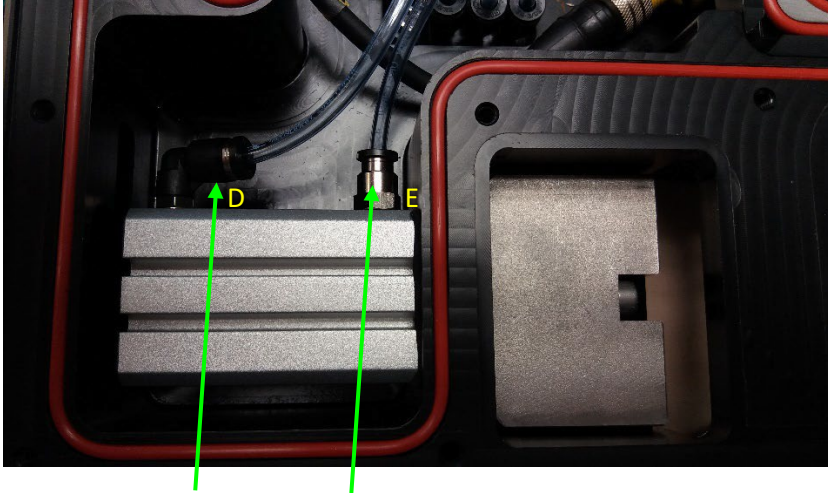

*Remove airline from connections D and E*

2. Remove Metal Pusher and Spacer by undoing the cap screw holding the pusher onto the cylinder ram using a long Allen key. Hold the cylinder ram in position with long nose pliers.

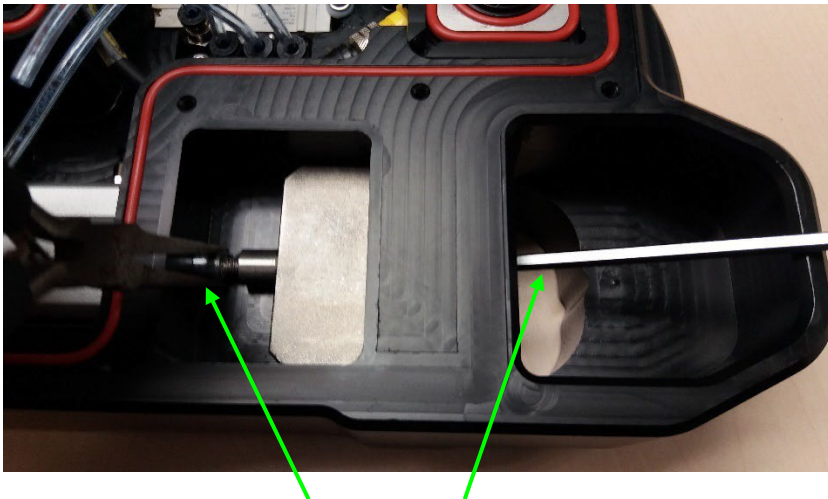

*Hold cylinder ram with pliers while undoing the cap screw with Allen Key*

3. Remove the M4 four cap screws.

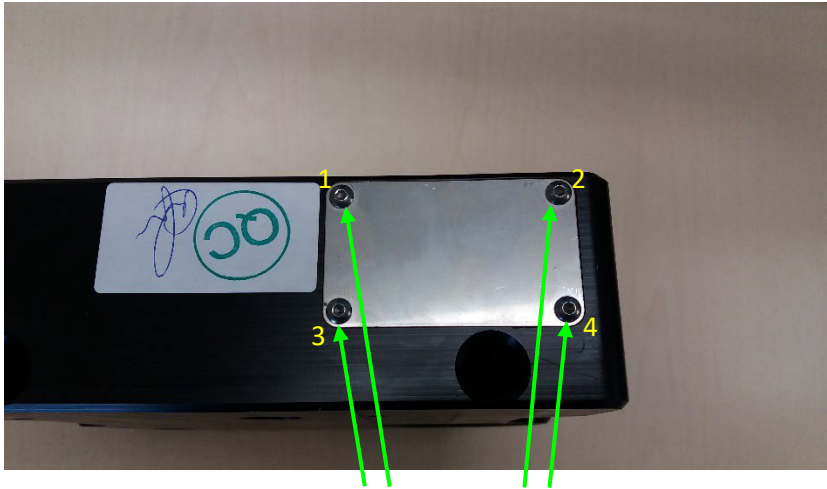

*Remove the four M4 cap screws*

4. Remove Cover Plate from the back of the dispenser base.

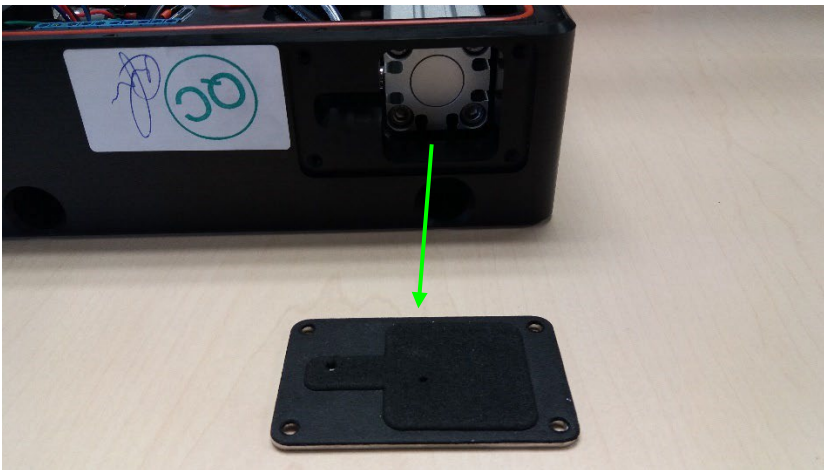

5. Remove the four cap screws holding the cylinder and slide it out through opening.

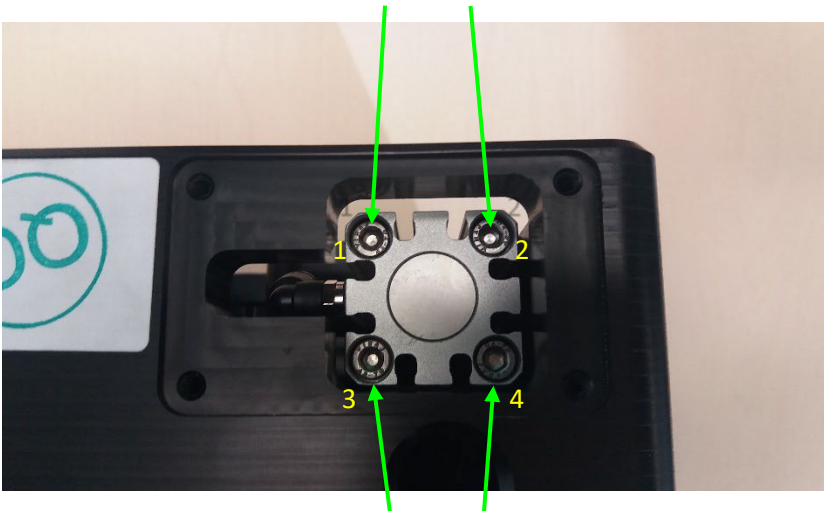

6. Remove the airline fittings from the old cylinder and refit to the new one using an 8mm spanner. Do not over tighten the fittings when reinstalling. Install the included new self-adhesive gasket. Align the gasket up with the screw holes when applying.

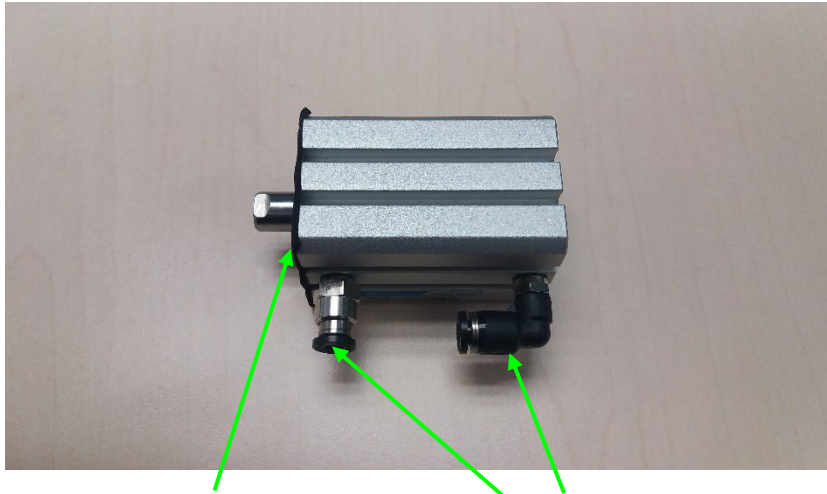

*Install new gasket*

*Install the airline fittings*

7. Refit cylinder and tighten the four retaining cap screws. Refit back cover plate and cam screws. Screw Pusher assembly onto cylinder ram (make sure spacer piece is in position)



*Ensure spacer is installed behind Pusher before reinstallation*

## 8. Appendix A: Wiring Schematic

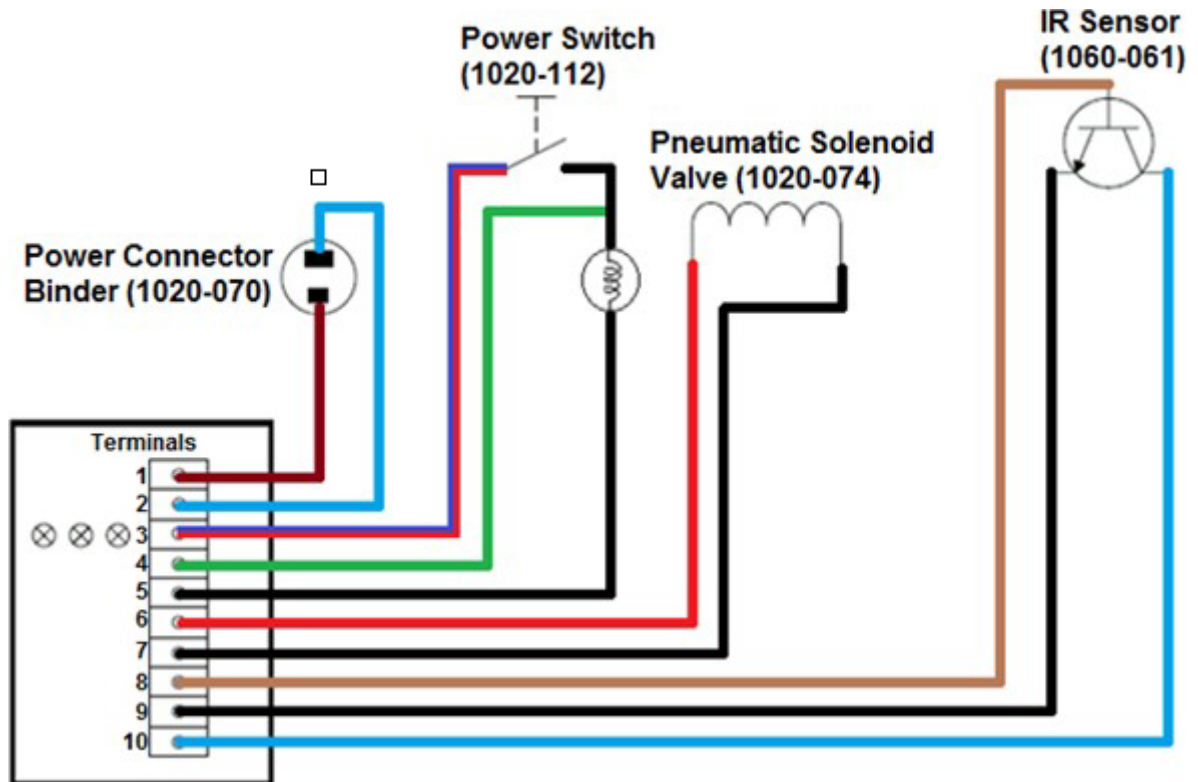

Terminal	Wire Colour	Component
1	Brown	Power Connector Binder
2	Light Blue	Power Connector Binder
3	Blue/Red	Power Switch
4	Green	Power Switch
5	Black	Power Switch
6	Red	Pneumatic Valve
7	Black	Pneumatic Valve
8	Brown	IR Sensor
9	Black	IR Sensor
10	Blue	IR Sensor

## 9. Appendix B: Main Assembly Diagram and Parts List

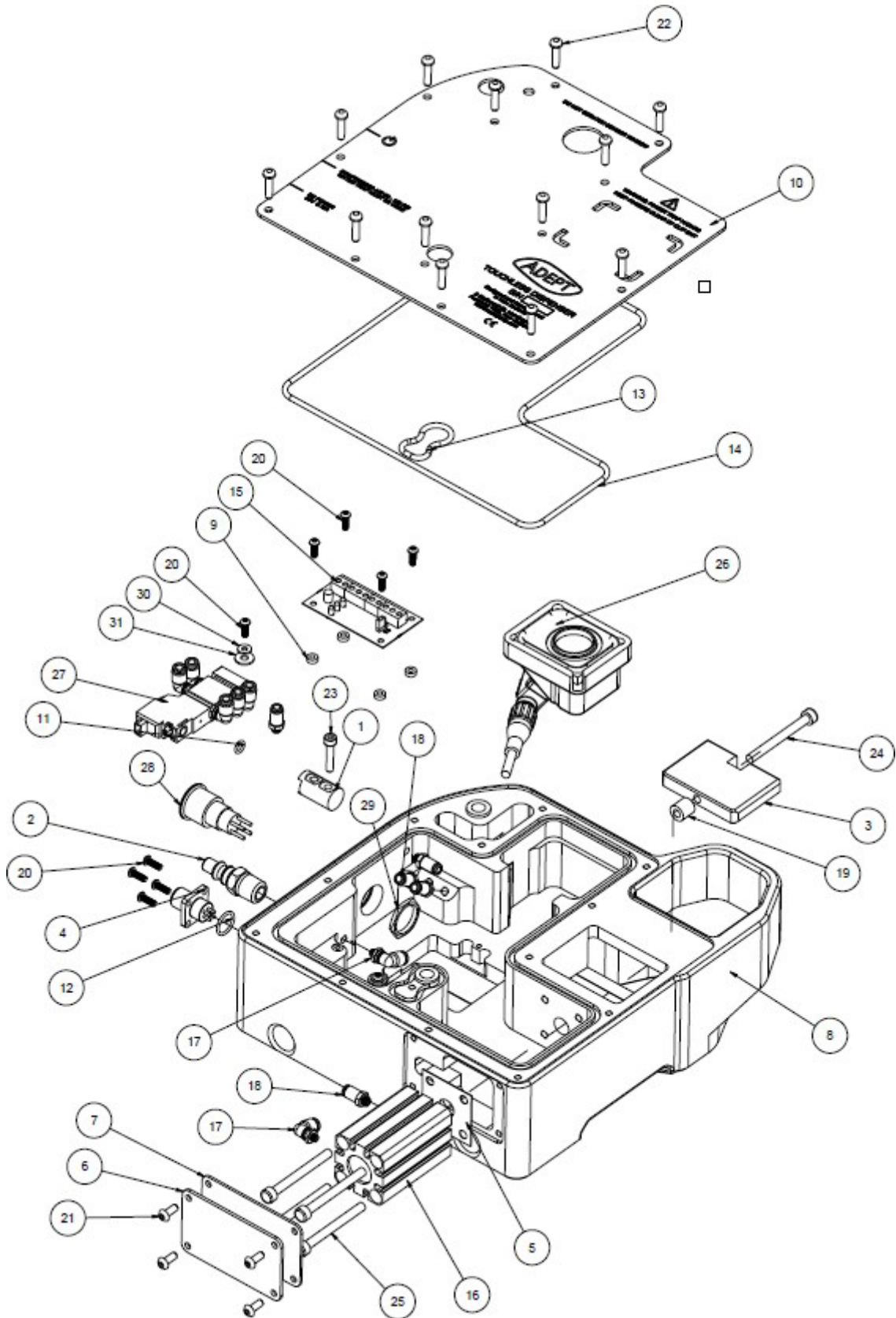

Item	Description	Part Number
1	Valve Vent Block	1020-110B
2	ARO Fitting ¼" X ¼" BSPT	1020-072
3	Clip Pusher	1020-045E
4	Power Connector Binder	1020-070
5	Cylinder Front Gasket	1020-059C
6	Cylinder Rear Cover S/S	1020-065D
7	Cylinder Rear Cover Gasket	1020-060D
8	Dispenser Base	1020-057S
9	Washer – M3 Nylon	n/a
10	Stainless-Steel Main Cover	1020-066J
11	O-Ring 5 x 1.5	1020-101
12	O-Ring 12 x 1.5	1020-080
13	O-Ring 26 x 3	1020-079
14	O-Ring 230 x 3	1020-077
15	PCB	1020-062F
16	Pneumatic Cylinder	1020-073
17	Air Line Fitting - Elbow	1020-076
18	Air Line Fitting - Straight	1020-075
19	Ram Spacer	1020-111
20	Cap Screw – M3 x 10	n/a
21	Cap Screw – M4 x 10	n/a
22	Cap Screw – M4 x 16	n/a
23	Cap Screw – M4 x 20	n/a
24	Cap Screw – M5 x 50	n/a
25	Cap Screw – M5 x 60	n/a
26	IR Sensor Assembly	<i>See Appendix C</i>
27	Pneumatic Solenoid Valve	1020-074
28	Power Switch	1020-112
29	Power Switch Nut	n/a
30	Washer – M3 Penny	n/a
31	Washer - Nylon	n/a

## 10. Appendix C: IR Sensor Assembly and Parts List

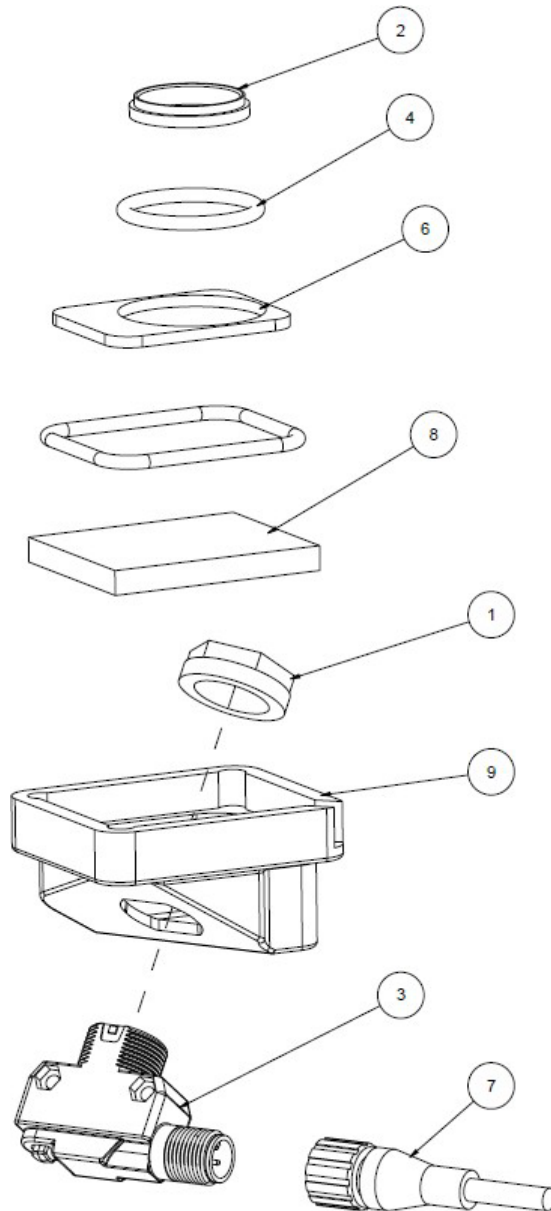

Item	Description	Part Number
1	Back Nut	n/a
2	Backup Ring	1020-109
3	IR Sensor	1020-061
4	O-Ring 26 x 3	1020-079
5	O-Ring 47 x 3	1020-103
6	O-Ring Carrier	1020-067D
7	IR Sensor Plug	1020-069
8	Sensor Glass	1020-063E
9	Sensor Mount	1020-095



## 11. Appendix D: Carousel Assembly and Parts List

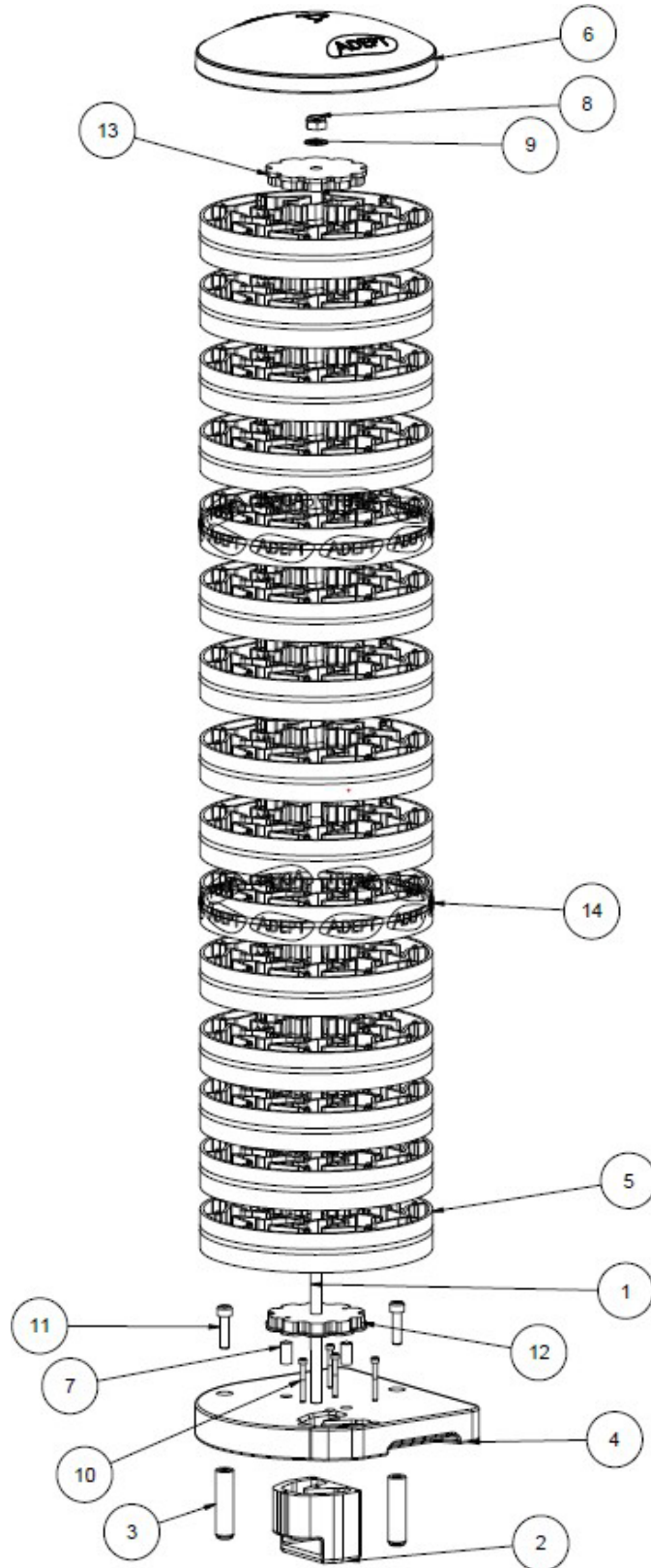

Item	Description	Part Number
1	Beef Clip Dispenser - SS Rod (500 Clip)	1020-055
1	Beef Clip Dispenser - SS Rod (750 Clip)	1020-056
2	TLD - Beef Clip Carousel - Chute	1020-049D
3	Carousel Legs S/S	1020-046C
4	TLD - Beef Clip Carousel - Main Plate	1020-48F
5	Beef Clip Dispenser - Cassette	1020-001E
6	Dispenser Cover	1213-001
7	Dispenser Ball Stop	1020-006
8	Dispenser Nut - M10 Nyloc Nut S/S	1020-003
9	Dispenser Washer - M10 Washer S/S	1020-004
10	Cap Screw - M4 x 35	1020-040
11	Cap Screw - M8 x 30	1020-098
12	Beef Clip Dispenser - Bottom Star	1224-012
13	Beef Clip Dispenser - Top Star	1224-011
14	Beef Clip Dispenser Cassette (White)	1020-502